

# SSH-C S-Group Pump Kit Selection Matrix

## Stainless Steel Close-Coupled Pumps 1750 RPM

Pump Size	Pump Unit						Required Kit Parts					
	Motor 1750 RPM			Impeller Diameter (inches)	1 Phase 115/230V Order Number	3 Phase 208-230/460V Order Number	Wet End Assembly Order Number	Impeller Order Number	Power End Adapter Order Number	1 Phase Motor Frame	3 Phase Motor Frame	
	Motor Enclosure	HP	JM Frame									
1 x 2-6	ODP	1/2	143	143	5%	9SH3C1D0	9SH4C51D0	9SHK6	2L886	1L554	C04711	C04731
	TEFC	1/2	143	143	5%	9SH3C1D0	9SH4C52D0				C04712	C04732
	ODP	1/2	143	143	5 1/16	9SH3C1C0	9SH4C51C0				C04711	C04731
	TEFC	1/2	143	143	5 1/16	9SH3C1C0	9SH4C52C0				C04712	C04732
	ODP	3/4	143	143	6 1/16	9SH3D1B0	9SH4D51B0				C05711	C05731
	TEFC	3/4	143	143	6 1/16	9SH3D1B0	9SH4D52B0				C05712	C05732
	ODP	3/4	143	143	6%	9SH3D1A0	9SH4D51A0				C05711	C05731
	TEFC	3/4	143	143	6%	9SH3D1A0	9SH4D52A0				C05712	C05732
1 x 2-8	ODP	3/4	143	143	7%	10SH3D11E0	10SH4D51E0	10SHK6	2L890	1L560	C05711	C05731
	TEFC	3/4	143	143	7%	10SH3D12E0	10SH4D52E0				C05712	C05732
	ODP	3/4	143	143	7%	10SH3D11D0	10SH4D51D0				C05711	C05731
	TEFC	3/4	143	143	7%	10SH3D12D0	10SH4D52D0				C05712	C05732
	ODP	1	143	143	7 1/16	10SH3E11C0	10SH4E51C0				C06711	C06731
	TEFC	1	145	143	7 1/16	10SH3E12C0	10SH4E52C0				C06712	C06732
	ODP	1 1/2	145	145	8 1/16	10SH3F11B0	10SH4F51B0				C07711	C07731
	TEFC	1 1/2	145	145	8 1/16	10SH3F12B0	10SH4F52B0				C07712	C07732
1 x 2-10	ODP	1 1/2	145	145	8 3/16	10SH3F11A0	10SH4F51A0	11SHK6	2L893	1L562	C07711	C07731
	TEFC	1 1/2	145	145	8 3/16	10SH3F12A0	10SH4F52A0				C07712	C07732
	ODP	2	182	145	8 3/4	11SH3G11D0	11SH4G51D0				C08711	C08731
	TEFC	2	182	145	8 3/4	11SH3G12D0	11SH4G52D0				C08712	C08732
	ODP	2	182	145	9%	11SH3G11C0	11SH4G51C0				C08711	C08731
	TEFC	2	182	145	9%	11SH3G12C0	11SH4G52C0				C08712	C08732
	ODP	3	184	182	9 1/32	11SH3H11B0	11SH4H51B0				C09711	C09731
	TEFC	3	184	182	9 1/32	11SH3H12B0	11SH4H52B0				C09712	C09732
1 1/2 x 2 1/2 -6	ODP	3	184	182	10 3/32	11SH3H11A0	11SH4H51A0	4SHK6	2L897	1L50	C09711	C09731
	TEFC	3	184	182	10 3/32	11SH3H12A0	11SH4H52A0				C09712	C09732
	ODP	1	143	143	6%	4SH3E11B0	4SH4E51B0				C06711	C06731
	TEFC	1	145	143	6%	4SH3E12B0	4SH4E52B0				C06712	C06732
1 1/2 x 2 1/2 -8	ODP	1 1/2	145	145	6 3/4	4SH3F11A0	4SH4F51A0	7SHK6	2L876	1L52	C07711	C07731
	TEFC	1 1/2	145	145	6 3/4	4SH3F12A0	4SH4F52A0				C07712	C07732
	ODP	1	143	143	6 1/16	7SH3E11E0	7SH4E51E0				C06711	C06731
	TEFC	1	145	143	6 1/16	7SH3E12E0	7SH4E52E0				C06712	C06732
	ODP	1 1/2	145	145	7	7SH3F11C0	7SH4F51C0				C07711	C07731
	TEFC	1 1/2	145	145	7	7SH3F12C0	7SH4F52C0				C07712	C07732
2 x 2 1/2 -6	ODP	2	182	145	8 1/4	7SH3G11A0	7SH4G51A0	5SHK6	2L757	1L50	C08711	C08731
	TEFC	2	182	145	8 1/4	7SH3G12A0	7SH4G52A0				C08712	C08732
	ODP	1	143	143	5%	5SH3E11E0	5SH4E51E0				C06711	C06731
	TEFC	1	145	143	5%	5SH3E12E0	5SH4E52E0				C06712	C06732
	ODP	1 1/2	145	145	5 13/16	5SH3F11C0	5SH4F51C0				C07711	C07731
	TEFC	1 1/2	145	145	5 13/16	5SH3F12C0	5SH4F52C0				C07712	C07732
2 x 2 1/2 -8	ODP	2	182	145	6%	5SH3G11A0	5SH4G51A0	8SHK6	2L766	1L99	C08711	C08731
	TEFC	2	182	145	6%	5SH3G12A0	5SH4G52A0				C08712	C08732
	ODP	1 1/2	145	145	6%	8SH3F11E0	8SH4F51E0				C07711	C07731
	TEFC	1 1/2	145	145	6%	8SH3F12E0	8SH4F52E0				C07712	C07732
	ODP	2	182	145	7 1/2	8SH3G11C0	8SH4G51C0				C08711	C08731
	TEFC	2	182	145	7 1/2	8SH3G12C0	8SH4G52C0				C08712	C08732
2 1/2 x 3 -6	ODP	3	184	182	8 1/4	8SH3H11A0	8SH4H51A0	6SHK6	2L770	1L99	C09711	C09731
	TEFC	3	184	182	8 1/4	8SH3H12A0	8SH4H52A0				C09712	C09732
	ODP	1 1/2	145	145	5%	6SH3F11G0	6SH4F51G0				C07711	C07731
	TEFC	1 1/2	145	145	5%	6SH3F12G0	6SH4F52G0				C07712	C07732
	ODP	2	182	145	6%	6SH3G11E0	6SH4G51E0				C08711	C08731
	TEFC	2	182	145	6%	6SH3G12E0	6SH4G52E0				C08712	C08732

continued from previous page

Pump Size	Pump Unit							Required Kit Parts						
	Motor 3500 RPM			Impeller Diameter (inches)	1 Phase 115/230V Order Number	3 Phase 208-230/460V Order Number	Wet End Assembly Order Number	Impeller Order Number	Power End Adapter Order Number	1 Phase Motor Frame	3 Phase Motor Frame			
	Motor Enclosure	HP	JM Frame									1 Ph	3 Ph	
1½ x 2½ -6	ODP	2	182	145	4 <sup>3</sup> / <sub>16</sub>	4SH1G21H0	4SH2G51H0	4SHK6	2L745	1L50	C08721	C08741		
	TEFC	2	145	182	4 <sup>3</sup> / <sub>16</sub>	4SH1G12H0	4SH2G52H0				C08722	C08742		
	ODP	3	182	145	4 <sup>11</sup> / <sub>16</sub>	4SH1H21F0	4SH2H51F0				2L869	C09721	C09741	
	TEFC	3	182	182	4 <sup>11</sup> / <sub>16</sub>	4SH1H12F0	4SH2H52F0				2L869	C09722	C09742	
	ODP	5	184	182	5 <sup>5</sup> / <sub>8</sub>	4SH1J21D0	4SH2J51D0				2L871	C10721	C10741	
	TEFC	5	184	184	5 <sup>5</sup> / <sub>8</sub>	4SH1J12D0	4SH2J52D0				2L871	C10722	C10742	
	ODP	7½		184	6 <sup>3</sup> / <sub>8</sub>		4SH2K51B0				2L874		C11741	C11741
	ODP	7½	213		6 <sup>3</sup> / <sub>8</sub>	4SH1K21B0					2L874		C11721	
	TEFC	7½	215	213	6 <sup>3</sup> / <sub>8</sub>	4SH1K12B0	4SH2K52B0				2L874	1L51	C11722	C11742
	ODP	10	215	213	6 <sup>3</sup> / <sub>4</sub>	4SH1L21A0	4SH2L51A0				2L876		C12721	C12741
TEFC	10	215	215	6 <sup>3</sup> / <sub>4</sub>	4SH1L12A0	4SH2L52A0	2L876	C12722	C12742					
1½ x 2½ -8	ODP	7½		184	6 <sup>7</sup> / <sub>16</sub>		7SH2K51E0	7SHK6	2L875	1L52		C11741		
	ODP	7½	213		6 <sup>7</sup> / <sub>16</sub>	7SH1K21E0					2L875	C11721		
	TEFC	7½	215	213	6 <sup>7</sup> / <sub>16</sub>	7SH1K12E0	7SH2K52E0				2L875	C11722	C11742	
	ODP	10	215	213	7	7SH1L21C0	7SH2L51C0				2L877	1L53	C12721	C12741
	TEFC	10	215	215	7	7SH1L12C0	7SH2L52C0				2L877		C12722	C12742
	ODP	15		215	8¼		7SH2M51A0				2L757			C13741
	TEFC	15		215	8¼		7SH2M52A0				2L757		C13742	
2 x 2½ -6	ODP	5	184	182	4 <sup>7</sup> / <sub>16</sub>	5SH1J21G0	5SH2J51G0	5SHK6	2L759	1L50	C10721	C10741		
	TEFC	5	184	184	4 <sup>7</sup> / <sub>16</sub>	5SH1J12G0	5SH2J52G0				2L759	C10722	C10742	
	ODP	7½		184	5 <sup>1</sup> / <sub>8</sub>		5SH2K51E0				2L881		C11741	
	ODP	7½	213		5 <sup>1</sup> / <sub>8</sub>	5SH1K21E0					2L881		C11721	
	TEFC	7½	215	213	5 <sup>1</sup> / <sub>8</sub>	5SH1K12E0	5SH2K52E0				2L881		C11722	C11742
	ODP	10	215	213	5 <sup>13</sup> / <sub>16</sub>	5SH1L21C0	5SH2L51C0				2L763	1L51	C12721	C12741
	TEFC	10	215	215	5 <sup>13</sup> / <sub>16</sub>	5SH1L12C0	5SH2L52C0				2L763		C12722	C12742
	ODP	15		215	6 <sup>7</sup> / <sub>8</sub>		5SH2M51A0				2L766			C13741
TEFC	15		215	6 <sup>7</sup> / <sub>8</sub>		5SH2M52A0	2L766		C13742					
2 x 2½ -8	ODP	10	215	213	6 <sup>3</sup> / <sub>16</sub>	8SH1L21F0	8SH2L51F0	8SHK6	2L764	1L98	C12721	C12741		
	TEFC	10	215	215	6 <sup>3</sup> / <sub>16</sub>	8SH1L12F0	8SH2L52F0				2L764	C12722	C12742	
	ODP	15		215	7 <sup>3</sup> / <sub>16</sub>		8SH2M51D0				2L767		C13741	
	TEFC	15		215	7 <sup>3</sup> / <sub>16</sub>		8SH2M52D0				2L767		C13742	
	ODP	20		254TCZ	7 <sup>3</sup> / <sub>4</sub>		8SH2N51B0				2L769		C14741B	
	TEFC	20		256TCZ	7 <sup>3</sup> / <sub>4</sub>		8SH2N52B0				2L769		C14742B	
	ODP	25		256TCZ	8¼		8SH2P51A0				2L770		C15741B	
2½ x 3 -6	ODP	10	215	213	5 <sup>5</sup> / <sub>8</sub>	6SH1L21G0	6SH2L51G0	6SHK6	2L777	1L98	C12721	C12741		
	TEFC	10	215	215	5 <sup>5</sup> / <sub>8</sub>	6SH1L12G0	6SH2L52G0				2L777	C12722	C12742	
	ODP	15		215	6 <sup>3</sup> / <sub>8</sub>		6SH2M51E0				2L775		C13741	
	TEFC	15		215	6 <sup>3</sup> / <sub>8</sub>		6SH2M52E0				2L775		C13742	
	ODP	20		254TCZ	6 <sup>15</sup> / <sub>16</sub>		6SH2N51C0				2L773		C14741B	
	TEFC	20		256TCZ	6 <sup>15</sup> / <sub>16</sub>		6SH2N52C0				2L773		C14742B	
	ODP	25		256TCZ	7 <sup>5</sup> / <sub>16</sub>		6SH2P51A0				2L771		C15741B	

# SSH-F S-Group Pump Kit Selection And Pricing

## AISI Type 304 Stainless Steel Frame-Mounted Pumps

Pump Size	Impeller Diameter (inches)	Pump Unit			Required Kit Parts			
		Max. BHP at RPM		Order Number	Wet End Assembly Order No. (Std. Imp.)	Impeller Order Number	Power End Adapter Order No.	Frame Assembly Order No.
		1750	3500					
1 x 2-6	5 <sup>3</sup> / <sub>8</sub>	.5	3	9SHFRM2D0	9SHK6	2L886	1L554	14L52
	5 <sup>11</sup> / <sub>16</sub>	.5	3.5	9SHFRM2C0		2L887		
	6 <sup>1</sup> / <sub>16</sub>	.65	5	9SHFRM2B0		2L888		
	6 <sup>3</sup> / <sub>8</sub>	.75	5.3	9SHFRM2A0		2L889		
1 x 2-8	7 <sup>1</sup> / <sub>8</sub>	.75	6.6	10SHFRM2E0	10SHK6	2L890	1L560	
	7 <sup>3</sup> / <sub>8</sub>	.85	7.5	10SHFRM2D0		2L891		
	7 <sup>11</sup> / <sub>16</sub>	1	8	10SHFRM2C0		2L892		
	8 <sup>1</sup> / <sub>16</sub>	1.3	10	10SHFRM2B0		2L893		
	8 <sup>27</sup> / <sub>64</sub>	1.5	11.1	10SHFRM2A0		2L898		
1 x 2-10	8 <sup>3</sup> / <sub>4</sub>	1.6	13.9	11SHFRM2D0	11SHK6	2L894	1L562	
	9 <sup>1</sup> / <sub>8</sub>	1.9	15	11SHFRM2C0		2L895		
	9 <sup>17</sup> / <sub>32</sub>	2.4	18.1	11SHFRM2B0		2L896		
	10 <sup>3</sup> / <sub>32</sub>	3.1	2.5	11SHFRM2A0		2L897		
1 1/2 x 2 1/2 -6	3 <sup>3</sup> / <sub>8</sub>	.5	2	4SHFRM2J0	4SHK6	2L744	1L50	
	4 <sup>3</sup> / <sub>16</sub>	.5	2.1	4SHFRM2H0		2L745		
	4 <sup>3</sup> / <sub>8</sub>	.5	3	4SHFRM2G0		2L746		
	4 <sup>11</sup> / <sub>16</sub>	.5	3.2	4SHFRM2F0		2L869		
	5 <sup>1</sup> / <sub>16</sub>	.6	5	4SHFRM2E0		2L870		
	5 <sup>5</sup> / <sub>8</sub>	.75	5.2	4SHFRM2D0		2L871		
	6 <sup>1</sup> / <sub>16</sub>	.8	7.5	4SHFRM2C0		2L872		
	6 <sup>3</sup> / <sub>8</sub>	1	7.8	4SHFRM2B0		2L874		
1 1/2 x 2 1/2 -8	6 <sup>3</sup> / <sub>4</sub>	1.1	10	4SHFRM2A0	7SHK6	2L876	1L52	
	6 <sup>1</sup> / <sub>8</sub>	1	7.5	7SHFRM2F0		2L751		
	6 <sup>7</sup> / <sub>16</sub>	1.1	7.7	7SHFRM2E0		2L875		
	6 <sup>3</sup> / <sub>4</sub>	1.5	10	7SHFRM2D0		2L876		
	7	1.5	10.5	7SHFRM2C0		2L877		
	7 <sup>13</sup> / <sub>16</sub>	1.7	15	7SHFRM2B0		2L756		
2 x 2 1/2 -6	8 <sup>1</sup> / <sub>4</sub>	2	16	7SHFRM2A0	5SHK6	2L879	1L50	
	4 <sup>1</sup> / <sub>8</sub>	.5	5	5SHFRM2H0		2L758		
	4 <sup>7</sup> / <sub>16</sub>	.6	5.2	5SHFRM2G0		2L759		
	4 <sup>13</sup> / <sub>16</sub>	.75	7.5	5SHFRM2F0		2L880		
	5 <sup>1</sup> / <sub>8</sub>	1	7.9	5SHFRM2E0		2L881		
	5 <sup>1</sup> / <sub>2</sub>	1.1	10	5SHFRM2D0		2L762		
	5 <sup>13</sup> / <sub>16</sub>	1.2	11	5SHFRM2C0		2L763		
	6 <sup>1</sup> / <sub>16</sub>	1.6	15	5SHFRM2B0		2L765		
2 x 2 1/2 -8	6 <sup>7</sup> / <sub>8</sub>	2	16	5SHFRM2A0	8SHK6	2L766	1L99	
	6 <sup>3</sup> / <sub>16</sub>	1.5	11	8SHFRM2F0		2L764		
	6 <sup>1</sup> / <sub>8</sub>	1.6	15	8SHFRM2E0		2L766		
	7 <sup>3</sup> / <sub>16</sub>	2	16	8SHFRM2D0		2L767		
	7 <sup>1</sup> / <sub>2</sub>	2.2	20	8SHFRM2C0		2L768		
	7 <sup>3</sup> / <sub>4</sub>	2.2	22	8SHFRM2B0		2L769		
2 1/2 x 3 -6	8 <sup>1</sup> / <sub>4</sub>	3	25	8SHFRM2A0	6SHK6	2L770	1L99	
	5 <sup>5</sup> / <sub>8</sub>	1.5	12	6SHFRM2G0		2L777		
	6 <sup>1</sup> / <sub>16</sub>	2	15	6SHFRM2F0		2L776		
	6 <sup>3</sup> / <sub>8</sub>	2.3	17	6SHFRM2E0		2L775		
	6 <sup>11</sup> / <sub>16</sub>	2.5	20	6SHFRM2D0		2L774		
	6 <sup>15</sup> / <sub>16</sub>	2.8	22	6SHFRM2C0		2L773		
	7 <sup>1</sup> / <sub>8</sub>	3.2	25	6SHFRM2B0		2L772		
7 <sup>3</sup> / <sub>16</sub>	3.4	28	6SHFRM2A0	2L771				

# SSH REPAIR PARTS

Effective January, 2008

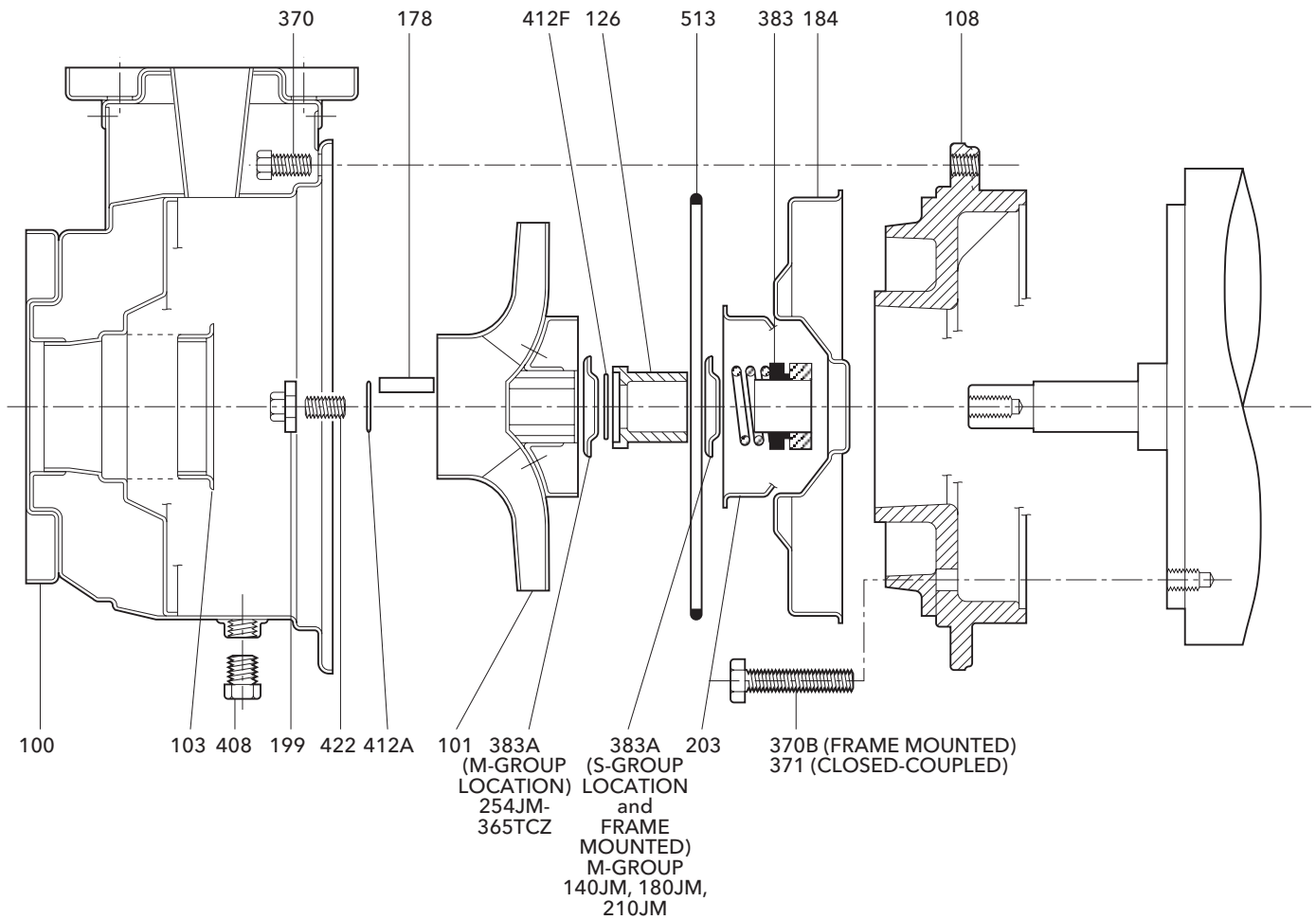

### SSH S-GROUP

Item No.	Part Description	Material	1 x 2-6		1½ x 2½-6		2 x 2½-6		2½ x 3-6		1 x 2-8		1½ x 2½-8		2 x 2½-8		1 x 2-10		Max. Wt. (lbs.)		
			①		②		4SH	5SH	6SH	①		7SH	8SH	①							
			9SH 9A-SH	9SH Before Jan. 2003	10SH 10A-SH	10SH Before Jan. 2003				11SH 11-SH	11SH Before Jan. 2003										
100	Casing with wear ring		1L450		1L453		1L456		1L459		1L451		1L454		1L457		1L452		17		
101	Impeller	AISI Type 316SS	6⅝	2L889	2L856	6¾	2L876	6⅞	2L766	7⅞	2L771	8 <sup>27</sup> / <sub>64</sub>	2L898		8¼	2L879	8¼	2L770	10 <sup>3</sup> / <sub>32</sub>	2L897	2L865
			6⅞	2L888	2L733	6⅞	2L874	6⅞	2L765	7⅞	2L772	8⅞	2L893	2L861	7 <sup>13</sup> / <sub>16</sub>	2L878	7¾	2L769	9 <sup>17</sup> / <sub>32</sub>	2L896	2L742
			5 <sup>11</sup> / <sub>16</sub>	2L887	2L853	6⅞	2L872	5 <sup>13</sup> / <sub>16</sub>	2L763	6 <sup>15</sup> / <sub>16</sub>	2L773	7 <sup>11</sup> / <sub>16</sub>	2L892	2L859	7	2L877	7½	2L768	9⅞	2L895	2L863
			5⅜	2L886	2L730	5⅝	2L871	5½	2L882	6 <sup>11</sup> / <sub>16</sub>	2L774	7⅞	2L891	2L858	6¾	2L876	7⅞	2L767	8¾	2L894	2L862
						5⅞	2L870	5⅞	2L881	6⅞	2L775	7⅞	2L890	2L735	6⅞	2L875	6⅞	2L766			
						4 <sup>11</sup> / <sub>16</sub>	2L869	4 <sup>13</sup> / <sub>16</sub>	2L880	6⅞	2L776				6⅞	2L873	6⅞	2L764			
						4⅜	2L868	4⅞	2L759	5⅝	2L777										
						4 <sup>3</sup> / <sub>16</sub>	2L867														
103	Wear ring, casing		4L465		4L466		4L467		4L468		4L465		4L466		4L467		4L465		1		
184	Seal housing with ring		1L465				1L469		1L472		1L466				1L470		1L467		3		
203	Wear ring, seal housing		4L201				4L464		4L201												
126	Shaft sleeve	316SS	4L473		4L456				4L473		4L456				4L473		4L456		1		
178	Key, impeller	Steel					4K11		4K555		4K11				4K555		4K11				
422	Stud, impeller		13K217																		
199	Washer, impeller	316SS	4L458																		
108	Motor adapter, 143-184JM and S-group brg. frame	Cast iron ASTM A48	1L554		1L50				1L99		1L560		1L52		1L99		1L562		1L97		25
	Motor adapter, 213-256JM	cl. 20	1L555		1L51				1L98		1L561		1L53		1L98		1L563		1L96		29
370	Bolt, casing	300SS	13L38 (8 req.)				13L89		13L38 (8 req.)				13L89 (8 req.)								
371 or 370B	Bolt, adapter, 143-184JM and S-Group brg. frame	Steel SAE 1200	13K360		13L43				13L43		13K360		13L43		13L43		13K360		13L43		25
	Bolt, adapter, 213-256JM		13K379		13L41				13K245		13K361		13L40		13K245		13K361		13L40		29
383	Mech. seal - standard	Type 21	10K27 - carbon/silicon-carbide/viton																		
	Mech. seal - high temp.		10K19 - Carbon/silicon-carbide/EPR																		
	Mech. seal - severe duty		10K64 - Silicon-carbide/silicon-carbide/viton																		
383A	Retainer, seal spring	316SS	4K517																		
408	Plug, vent and drain	316SS	6L60																		
412A	O-ring, impeller washer	Viton	5K320 standard (5K195 EPR option)																		
412F	O-ring, shaft sleeve	Viton	5K307 standard (5K306 EPR option)																		
513	O-ring, casing - standard	Viton	5K407				5L70		5K408				5L70		5L71						
	O-ring, casing - optional	EPR	5K393				5K317		5K394				5K317		5L110						

① 9SH, 10SH and the 11SH units were obsoleted in January 2003 and replaced by the 9ASH, 10ASH and 11ASH units.

② New numbering system on September of 2006 dropped the "A". There was no mechanical change.

### SSH M-GROUP (254JM-365TCZ)

Item No.	Part Description	Material	1½ x 2½-10 24SH	2 x 2½-10 25SH	2½ x 3-8 22SH	2½ x 3-10 27SH	3 x 4-8 23SH	3 x 4-10 28SH	Max. Wt. (lbs.)						
100	Casing, with wear ring	AISI Type 316L SS	1L455		1L458		1L460		1L461		1L463		1L464		17
101	Impeller		9⅞	2L778	9⅞	2L790	9⅞	2L808	10⅝	2L804	9⅞	2L825	10⅝	2L836	8
			9½	2L779	9½	2L791	8¾	2L809	9¹⁵⁄₁₆	2L805	8¹¹⁄₁₆	2L826	10¼	2L837	
			9¹⁄₁₆	2L780	9⅞	2L792	8½	2L810	9⅞	2L806	8⅞	2L827	9¹³⁄₁₆	2L838	
			8⅞	2L781	8¹³⁄₁₆	2L793	8¼	2L811	9¼	2L807	8⅞	2L828	9⅞	2L839	
			8⅞	2L782	8³⁄₁₆	2L794	7⅞	2L812	8¾	2L809	7¹¹⁄₁₆	2L829	9⅞	2L825	
			8¼	2L783	7¹⁵⁄₁₆	2L795	7½	2L813			7½	2L830	8¹¹⁄₁₆	2L826	
					7¹¹⁄₁₆	2L796	7⅞	2L814			7⅞	2L831			
							6¹¹⁄₁₆	2L815			6⅞	2L832			
							6½	2L816			6½	2L833			
											6	2L834			
									5½	2L835					
103	Wear ring, casing		4L467			4L468			4L469			1			
184	Seal housing, with ring		1L468			1L473	1L475	1L477	1L478	3					
203	Wear ring, seal housing		4L201			4L464						1			
126	Shaft sleeve	316 SS	4L457												
178	Key, impeller	Steel	4K261												
422	Stud, impeller		13K301												
199	Washer, impeller	316 SS	4L463												
108	Motor adapter, 254-256JM and M-Group bearing frame	Cast iron ASTM A48 cl. 20	1L91		1L89		1L93		1L94		31				
	Motor adapter, 280JM-365TCZ		1L90		1L88		1L92		1L95		44				
370	Bolt, casing	300 SS	13L86 (6 req'd)		13L89 (8 req'd)		13L86 (8 req'd)		13K45 (8 req'd)		-				
371 or 370B	Bolt, adapter, 254-256JM and S-Group bearing frame	Steel SAE 1200	13L88			13L116			-						
	Bolt, adapter, 280JM-365TCZ		13L87			13L115			-						
383	Mech. seal - standard	Type 21	10K45 - carbon/silicon-carbide/ viton						1						
	Mech. seal - high temp.		10K20 - Carbon/silicon-carbide/EPR												
	Mech. seal - severe duty		10K65 - Silicon-carbide/silicon-carbide/viton												
383A	Retainer, seal spring	316SS	4K500												
408	Plug, vent and drain	316SS	6L60						2						
412A	O-ring, impeller washer	Viton	5K309 standard (5K308 EPR option)						1						
412F	O-ring, shaft sleeve	Viton	5K309 standard (5K308 EPR option)												
513	O-ring, casing - standard	Viton	5L71		5L70		5L71			5L72					
	O-ring, casing - optional	EPR	5L110		5K317		5L110		5L116						

## SSH M-GROUP (140JM, 180JM & 210JM)

Item No.	Part Description	Material	1½ x 2½-10 24SH	2 x 2½-10 25SH	2½ x 3-8 22SH	2½ x 3-10 27SH	3 x 4-8 23SH	Max. Wt. (lbs.)					
100	Casing, with wear ring	AISI Type 316L SS	1L455		1L458		1L460		1L461		1L463		17
101	Impeller		9 <sup>7</sup> / <sub>8</sub>	2L784	9 <sup>7</sup> / <sub>8</sub>	2L797	9 <sup>1</sup> / <sub>6</sub>	2L820	9 <sup>5</sup> / <sub>16</sub>	2L817	9 <sup>1</sup> / <sub>6</sub>	2L840	8
			9 <sup>1</sup> / <sub>2</sub>	2L785	9 <sup>1</sup> / <sub>2</sub>	2L798	8 <sup>1</sup> / <sub>2</sub>	2L822	9 <sup>9</sup> / <sub>16</sub>	2L818	8 <sup>7</sup> / <sub>16</sub>	2L841	
			9 <sup>5</sup> / <sub>16</sub>	2L786	9 <sup>5</sup> / <sub>16</sub>	2L799	8 <sup>3</sup> / <sub>4</sub>	2L823	9 <sup>1</sup> / <sub>4</sub>	2L819	8 <sup>5</sup> / <sub>16</sub>	2L842	
			8 <sup>7</sup> / <sub>8</sub>	2L787	8 <sup>3</sup> / <sub>16</sub>	2L800	7 <sup>7</sup> / <sub>8</sub>	2L824	8 <sup>3</sup> / <sub>4</sub>	2L821	7 <sup>1</sup> / <sub>2</sub>	2L843	
			8 <sup>5</sup> / <sub>16</sub>	2L788	8 <sup>3</sup> / <sub>16</sub>	2L801	7 <sup>7</sup> / <sub>8</sub>	2L772			7 <sup>7</sup> / <sub>8</sub>	2L844	
			8 <sup>1</sup> / <sub>4</sub>	2L789	7 <sup>1</sup> / <sub>16</sub>	2L802	6 <sup>1</sup> / <sub>16</sub>	2L774			6 <sup>1</sup> / <sub>2</sub>	2L845	
					7 <sup>1</sup> / <sub>16</sub>	2L803					6	2L846	
									5 <sup>1</sup> / <sub>2</sub>	2L847			
103	Wear ring, casing			4L467			4L468			4L469			1
184	Seal housing, with ring		1L467			1L472		1L474		1L476		3	
203	Wear ring, seal housing		4L201			4L464						1	
126	Shaft sleeve	316SS	4K501			4L456							
178	Key, impeller	Steel	4K11										
422	Stud, impeller		13K217										
199	Washer, impeller	316 SS	4L458										
108	Motor adapter, 143-184JM and S-group bearing frame	Cast iron ASTM A48 cl.20	1L97			1L99		N/A		1L123			25
	Motor adapter, 213-256JM		1L96			1L98		1L100					29
370	Bolt, casing	300 SS	13L86 (8 req'd)			13L89 (8 req'd)		13L86 (8 req'd)					-
371 or 370B	Bolt, adapter, 143-184JM and S-group bearing frame	Steel SAE 1200	13L43				N/A		13L117				-
	Bolt, adapter, 213-256JM		13K245						13K44				-
383	Mechanical seal - standard	Type 21	10K27 - carbon/silicon-carbide/viton									1	
	Mechanical seal - high temp.		10K19 - Carbon/silicon-carbide/EPR										
	Mechanical seal - severe duty		10K64 - Silicon-carbide/silicon-carbide/viton										
383A	Retainer, seal spring	316 SS	4K517										
408	Plug, vent and drain	316 SS	6L60									2	
412A	O-ring, impeller washer	Viton	5K320 standard (5K195 EPR option)									1	
412F	O-ring, shaft sleeve	Viton	5K320 standard (5K195 EPR)			5K307 standard (5K306 EPR option)							
513	O-ring, casing - standard	Viton	5L71			5L70		5L71					
	O-ring, casing - optional	EPR	5L110			5K317		5L110					

### Xylem Inc.

2881 East Bayard Street Ext., Suite A, Seneca Falls, NY 13148

Phone: (800) 453-6777 Fax: (888) 322-5877

www.gouldswatertechnology.com

